

AERODROME CHART

52° 09' 57" N
020° 58' 02" E

ELEV: 362ft

TWR 118.300
GND 121.900

WARSAW / CHOPIN

FS9/FSX/P3D conditional lights: NAV2 112.00MHz

FOR DETAILS SEE CHART
AD 2 EPWA 1-1-2

ELEVATIONS IN FEET
DIMENSIONS IN METRES
BEARINGS ARE MAGNETIC
TAXIWAYS: 23m WIDE EXPECT TWY K 15 m WIDE
TWY B1 11 m WIDE

ZB1, ZB2 - TWY Z BLUE 1,2
Z01, Z02 - TWY Z ORANGE 1,2

| LEGEND | |
|-------------------------------------|-----|
| AIRCRAFT STAND | ●1 |
| POINT LIGHT | ○ |
| POLE, TOWER, SPIRE, ANTENA, ETC. | ⊙ |
| APRON LIGHT | ✱ |
| TAXI - HOLDING POSITION | ≡≡≡ |
| INS COORDINATES FOR AIRCRAFT STANDS | |

| LIGHTING | | | | | BEARING STRENGTH |
|----------|---------|-------|-----------|-----|----------------------|
| RWY No | APCH | THR | RWY | END | RWY: PCN 60/F/B/X/T |
| 33 | W/R LIH | G LIH | W/Y/R LIH | RED | TWYs: PCN 46 F/B/X/T |
| 15 | W LIH | G LIH | W/Y/R LIH | RED | |
| 11 | W/R LIH | G LIH | W/Y/R LIH | RED | |
| 29 | W LIH | G LIH | W/Y/R LIH | RED | |

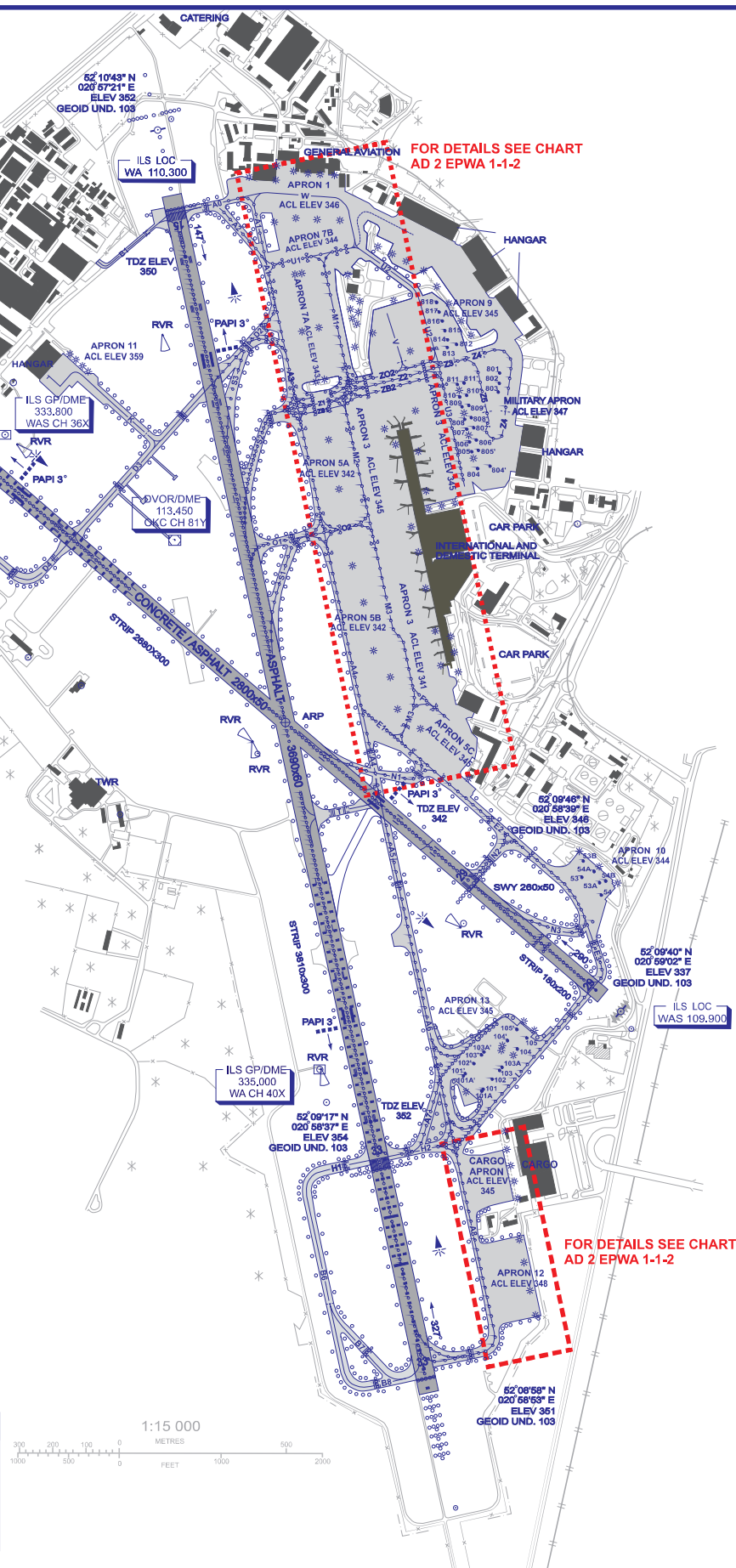

FOR DETAILS SEE CHART
AD 2 EPWA 1-1-2

AERODROME CHART

52° 09' 57" N
020° 58' 02" E

ELEV: 362ft

TWR 118.300
GND 121.900

WARSAW / CHOPIN

